

PRODUCED BY AN AUTODESK EDUCATIONAL PRODUCT

PRODUCED BY AN AUTODESK EDUCATIONAL PRODUCT

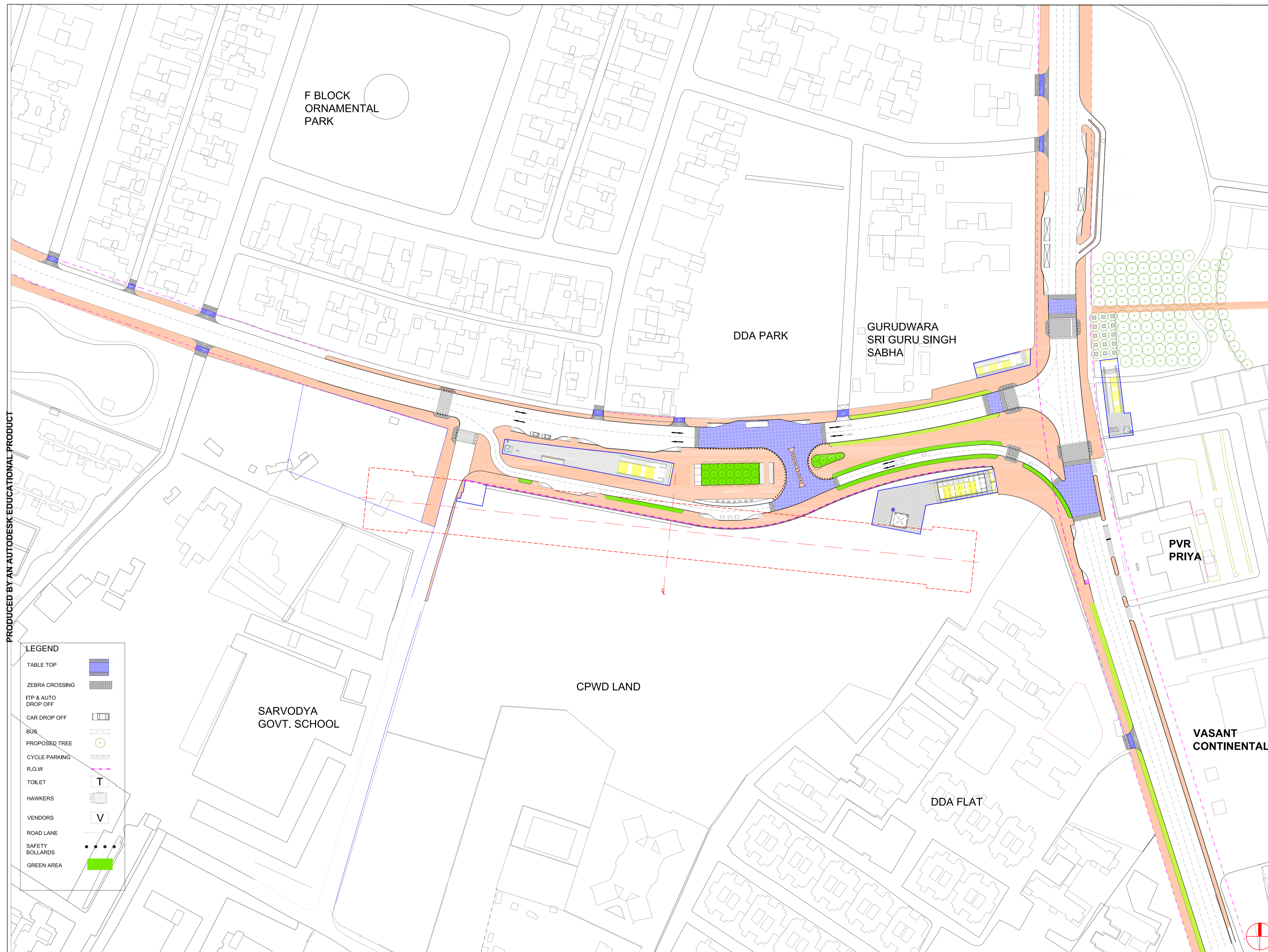

The following recommendations/ decisions were taken for the project of Multi-Modal Integration Plan of Vasant Vihar Metro Station:

Recommendations of the Working Group Meeting dated 26.05.2014 :

- i. U-Turn not to be added on the central verge. Widening of U-Turn & Geometry for turning with median. U-Turn to be introduced approximately 100-120 m. from the junction.
- ii. No channelizes at junction, proper crossing. Table top crossing at Bus Stop to be made. Proper NMT crossing to be made. Signal/ rotary at main Priya crossing is recommended.
- iii. New Slip road on the green area to be provided for providing IPT drop off and other vehicular movement. New slip road to be end before the T-junction to avoid traffic conflict at the junction.
- iv. Vehicular and pedestrian access to CPWD site to be provided. CPWD site to be developed as per TOD norms and redevelopment of District Centre (Chief Architect may explore the possibility).
- v. Working Group agreed for PWD and DMRC as the implementing agency

With above recommendations, WG-IIB dated 26.5.14 recommended this proposal to be placed before the Governing Body.

Decision of the Governing Body dated 29.05.2015:

The Governing Body approved the proposal.

Note:

- 1. Approval of the Governing Body is for transportation and circulation plan only. Implementation of circulation plan will be the responsibility of the Delhi Traffic Police and Executing/ implementing Agencies.
- 2. This is the conceptual drawing and detailed engineering design is to be evaluated by Road Owning Agency.
- 3. Structural engineering safety/ road geometrics features are strictly to be followed by the implementing agency as per the Bureau of Standards (BIS)/ Indian Road Congress (IRC).
- 4. UTTIPEC's Street Design Guidelines approved by the Hon'ble L.G. on 25.11.2010 to be followed by the Executing/ implementing agencies.
- 5. Acquisition of land for implementation of project shall be the responsibility of Executing/ implementing agencies.
- 6. All required statutory clearances are to be obtained by the executing/ implementing agencies.
- 7. The necessary permission for cutting of trees shall be obtained by the executing/ implementing agencies from concerned deptt. as per the existing policy.
- 8. Drawings for the construction are to be prepared by the Road Owning Agency.

Multi- Modal Integration (MMI) Concept Plan of Vasant Vihar Metro Station

Drawing No. /MMI/15



Unified Traffic & Transportation (Planning and Engineering) Center UTTIPEC

AKSHAY KAUL & ASSOCIATES
199 POCKET B, SUKHODEV VIHAR
NEW DELHI - 110025
TEL. - 011 26311435
EMAIL - aklandscape@gmail.com

[Signature]
Plg. Asstt. UTTIPEC

[Signature]
Dy. Dir. (Arch.) UTTIPEC

[Signature]
Dir. (Plg.) UTTIPEC